

/ INTERFACE CONNECTIONS

- ① Insert the incoming Cat5/6 data cable into either RJ45 port.
- ② Insert the outgoing Cat5/6 PoE cable into either RJ45 port.

Note: PoE can be delivered from ports P1 & P2 at the same time allowing for up to 2 PoE devices to be powered.

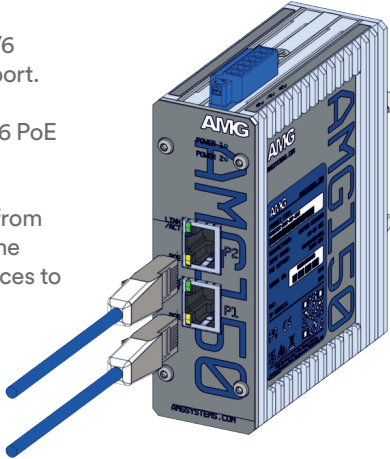

/ PORT SPEEDS

Example part code:

AMG150-2GAT-P60

Character	RJ45 Port Speed
F	10/100 Base-T(X)
G	10/100/1000 Base-T(X)

/ POE CAPABILITIES

Example part code:

AMG150-2GAT-P60

Characters	PoE Standard Supported
None	Non-PoE Model
AT	IEEE 802.3at 30W Port
BT	IEEE 802.3bt 60/90W Port

Check the product label to determine the PoE power supported on each port and the units total maximum PoE budget.

Characters	PoE Budget
P30	30W Max
P60	60W Max
P90	90W Max
P180	180W Max

Ensure the PSU size used is at least equal to the maximum PoE budget figure.

**IEEE 802.3at Models**  
Type 1 & 2 PoE support  
Mode A PSE only

**IEEE 802.3bt Models**  
Type 1, 2, 3 & 4 PoE support. Mode A and/or Mode B PSE



SCAN ME

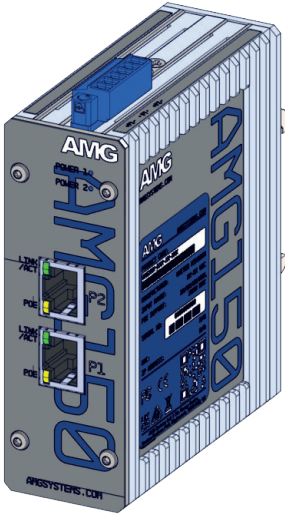

# AMG150 Series Industrial 2-Port PoE Injector

Installation Manual - Hardware

## / DIN RAIL MOUNT INSTALLATION

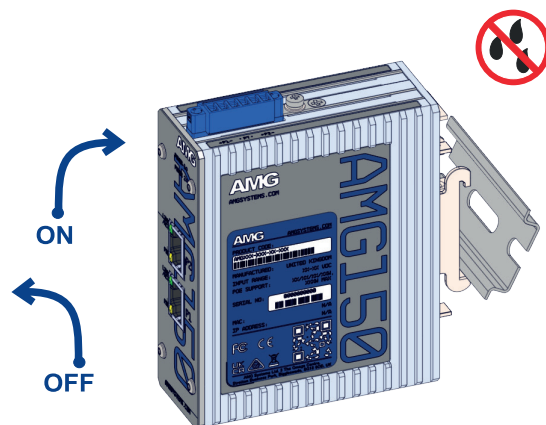

## / SURFACE MOUNT INSTALLATION

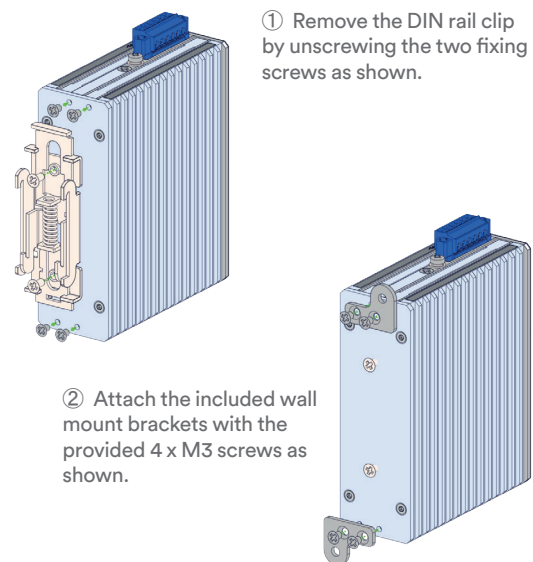

## / IP RATING

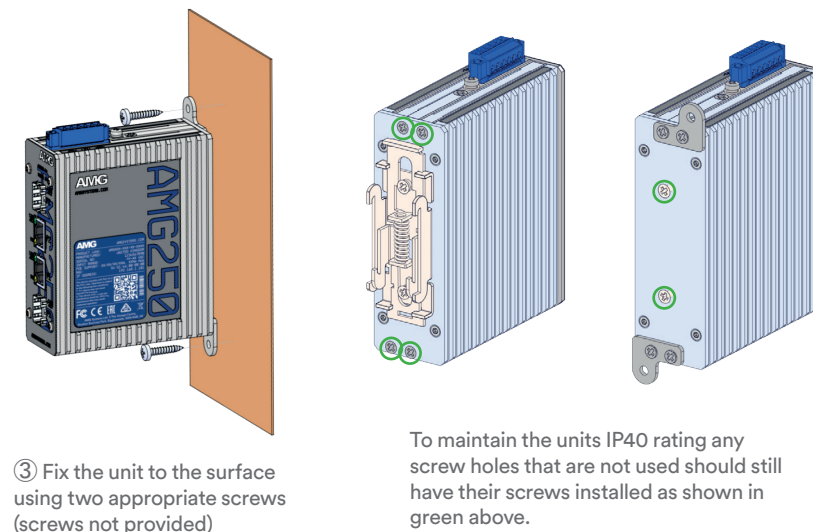

## / POWER

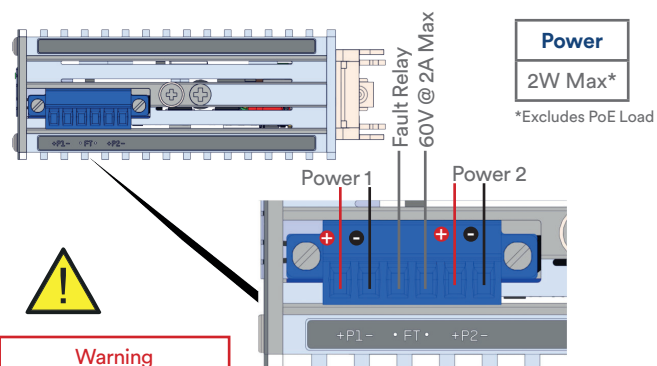

**Warning**  
Do not exceed the rated voltage. Observe correct voltage polarity.

Model Type	Voltage
30W PoE Models	48-56 VDC
90W PoE Models	52-56 VDC

Fault relay is normally closed and will open on either power failure. If used with a single PSU, the PSU should be wired to both power inputs.

## / EARTH PROTECTION



To provide correct protection from ESD and Surge events ensure that the unit is correctly earthed using the provided earth connection point in accordance with local electrical codes & standards. (cable not provided)

## / LED INDICATORS

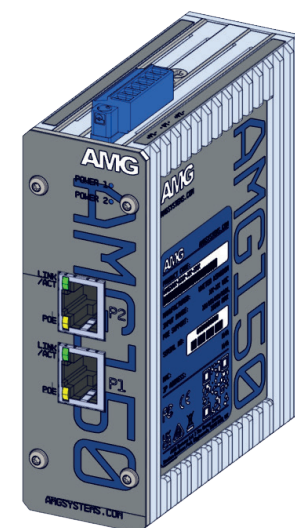

LED	Colour	Description
POWER 1	Blue	DC input present on power 1
POWER 2	Blue	DC input present on power 2
RJ45 LINK/ACT	Off	No Ethernet link connection
	Green	Ethernet link present (flashes with data traffic activity)
POE	Off	No PoE being supplied
	Yellow	PoE is being delivered on the port